

DIN 7965

- Yarıklı Somun
- Screwed Inserts
- Einschraubmuttern

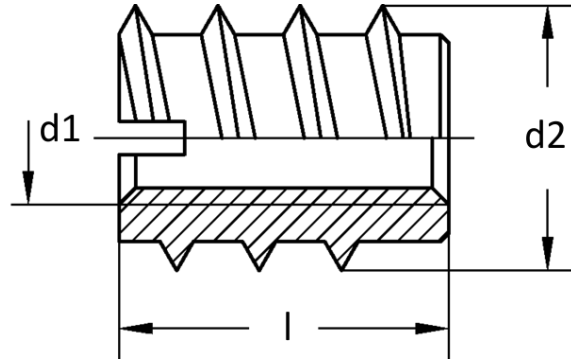

d1	M 3	M 4	M 5	M 6	M 8	M 10	M 12	M 16	M 20
d2	6	8	10	12	16	18,5	22	25	29
l	8-12	8-15	10-20	12-30	18-30	20-40	25-30	25-30	25-30